

State of Mississippi
 Department of Archives and History
 P.O. Box 571
 Jackson, MS 39205

HISTORIC RESOURCES INVENTORY

1.a. Property Name, Historic Walton-Young House		14. MDAH Inventory Code 379
1.b. Property Name, Common Stark Young House		15. County Lafayette
2. Property Address 420 (?) University Avenue		16. City Oxford
3. Legal Description 97B:193		20. USGS Quad Map
19. Ownership public	22. Condition fair	21. UTM Reference
4. Former/Historic Uses residence	5. Present Use museum	24. Principal Materials frame
6 & 7. Significant persons, events, themes, including dates of association Stark Young, novelist		
8. Date of Construction ca. 1880	9. Historic Changes porch ca. 1925	23. Post Historic Changes
10. Architect	11. Builder/Contractor	25. Architectural Style Italianate/Queen Ann

13. Outbuildings or Secondary Features (use sep. form if important)

12. Brief Description: Two-story, three-bay, frame gable and wing house with Italianate and Queen Anne influence, built ca. 1880 and altered with Craftsman influence in ca. 1925. Gable and hip roofs covered with asphalt shingles, with plain projecting eaves. Exterior walls covered with weatherboard siding; a two-story bay window projects from the front wing. Windows are 2/2 double-hung sashes, some set in semi-circular arched reveals with semi-circular arched hoods, and some with segmental arched hoods.

30. Historical Information: This structure was once home to John Stark, a regional novelist. The house was given to the University of Mississippi in the 1970s.

31. Historical Contexts:

33. Sources of Information:

MISSISSIPPI HISTORIC RESOURCES INVENTORY

Page 2

32. Additional Remarks or Information: #12, continued: Partial-width, hip roof porch supported by battered box piers set on brick bases. Entrance contains a single-light, multi-panel Queen Anne cottage double door, topped with a single-light transom.

35. Owner's Name and Address

36. Photographer/Source
John Hopkins

37. Photo Roll/Frame
3562:14

38. Photo Date
January, 2000

39. Form by Hopkins & Associates, Memphis, TN

40. Survey Project Oxford

Date of Form January, 2000

Attach Photograph



MDAH INFORMATION

26. Category

27. Functional Type

28. Registration Status/Dates
NHL
Listed NR
In NR District
Federal DOE
State Landmark
Local Landmark
In Local District
HABS/HAER

29. District Name

Rating C/N C
Inventory #

42. Other HPD Information

43. Evaluation

a. Already Listed NR
Individually Eligible
Eligible if Restored
Contribute to District
Apparently Not Eligible
Insufficient Information
Not Extant

b. Area(s) of Significance

c. Evaluated by/date

420(?) University Ar
Walton Young Hous.

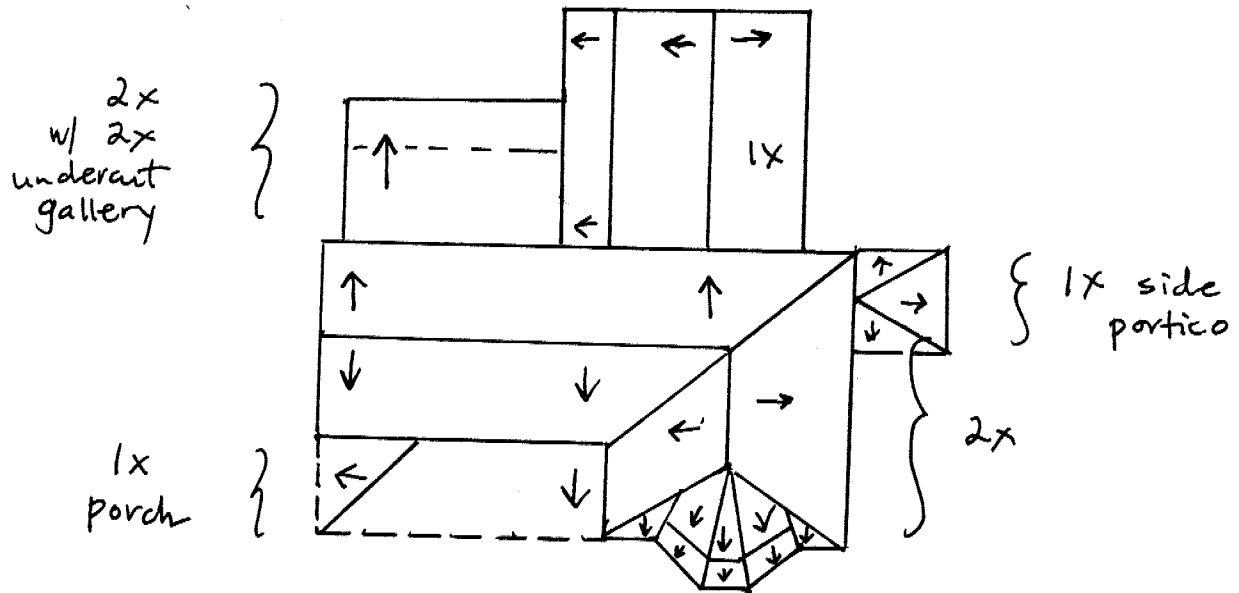

↓ N 420? University